



BRAMBLE

PRODUCT TEARSHEET



Eton 2 Drawer Console

Shown in: **SNW**

SKU: **26583**

Size: **48W x 16D x 31H in**



Overview

Simple and refined, the Eaton 2-Drawer Console offers stylish storage and display potential to the home. Crafted with solid mahogany wood, this console includes a pair of dovetail drawers with solid brass hardware. This piece is offered with a vast array of finish and distress options to create a truly custom design.



TOP VIEW

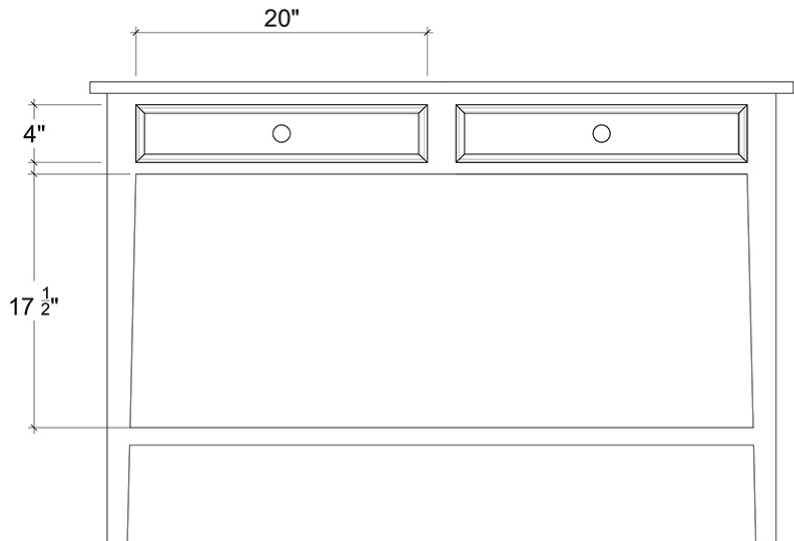

FRONT VIEW

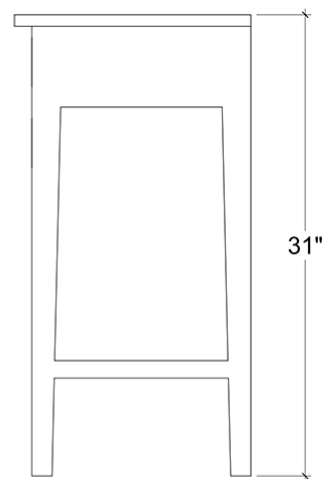

SIDE VIEW

Visual Highlights



Technical Specification

Dimensions	48W x 16D x 31H in	CBM	0.49
Number of Packages	1	Cubic Feet	17.3 ft³
Package 1 Dimensions	51.2 x 19.3 x 37 in	Package 1 Weight	52.91 lbs
Package Weight Total	52.91 lbs	Net Weight	46.3 lbs
Material	Mahogany		

<https://www.brambleco.com/26583>
